

REV	DESCRIPTION	DATE
A	Initial Release	16.12.16

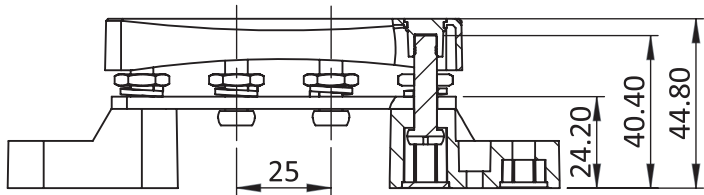

BF423-4P / BF423C-4P (with cover)

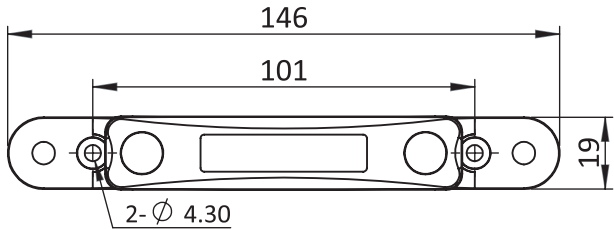
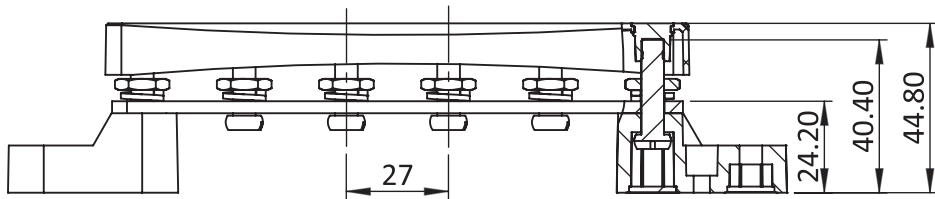
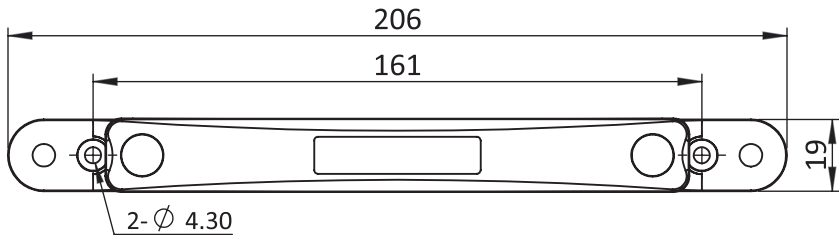

BF423-6P / BF423C-6P (with cover)

Size	0.5-6	>6-30	>30-120	>120-400
Tol	+/-0.05	+/-0.1	+/-0.15	+/-0.2

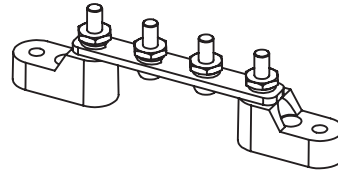

BSB-S-423-4P

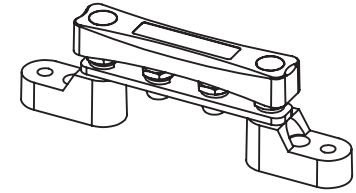

C-BSB-S-423-4P

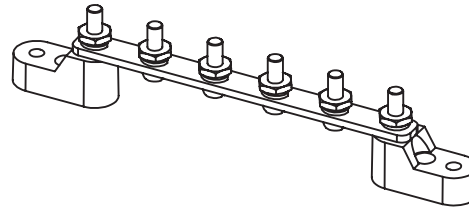

BSB-S-423-6P

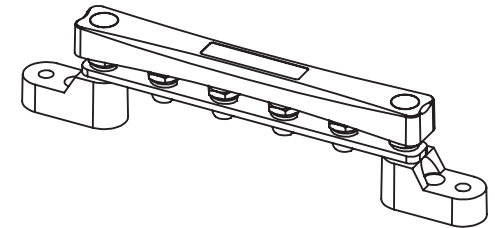

C-BSB-S-423-6P

Features

- Glass fiber reinforced Nylon base ensures great mechanical strength and durability
- Optional transparent insulating cover with recessed area for label stickers
- Tin-plated Brass bus allowing current up to 100A
- Stainless steel studs and screws provide great anti-corrosion ability on board
- Insulated base ensures no leakage to metal hulls

Product ID	Struds	Screws	Rating	Bus Material
BF423-4P	4 x M6 (1/4")	-	100A	Brass
BF423-6P	6 x M6 (1/4")	-	100A	Brass

	Truecom Technology Corp.			DRAWN BY	TOMMY
				CHECKED	TOMMY
TITLE:	Single Bus Bars			APPROVED	CAROL
PART NO:	BSB-423-xP / C-BSB-423-xP			DRAWING NO.	
SCALE	1:2	REV	A	UNIT	mm